

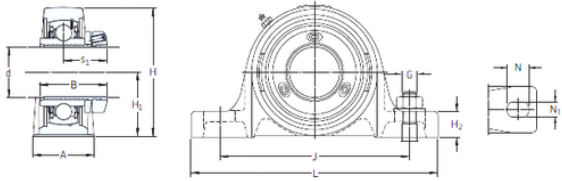

# Qingdao Clunt Bearing Co., Ltd.



## SKF SY 25 PF bearing units

Bearing No. SY 25 PF

Bore Diameter	25 mm
Width	41 mm
d	25 mm
s1	29 mm
A	36 mm
B	41 mm
G	10 mm
H	70 mm
H1	36,5 mm
H2	16 mm
J	102 mm
L	130 mm
N	19,5 mm
N1	11,5 mm
Weight	0,85 Kg
Basic dynamic load rating (C)	14 kN
Basic static load rating (C0)	7,8 kN

SY 25 PF Bearing 2D drawings and 3D CAD models