

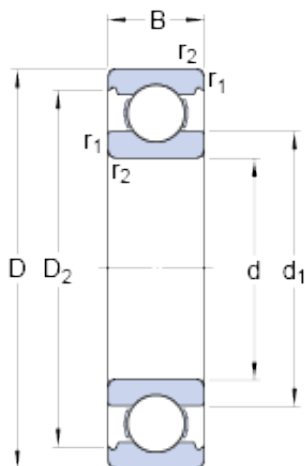

Qingdao Clunt Bearing Co., Ltd.



6215 Bearing 2D drawings and 3D CAD models

Made in France types of SKF deep groove ball bearing 6215 2Z C4 SKF 6215 bearing

Bearing No. 6215

Size	130x75x25 mm
Bore Diameter	130 mm
Outer Diameter	75 mm
Width	25 mm
d	75 mm
D	130 mm
B	25 mm
d ₁	92.05 mm
D ₂	116.5 mm
r _{1,2} - min.	1.5 mm
d _a - min.	84 mm
D _a - max.	121 mm
r _a - max.	1.5 mm
Basic dynamic load rating - C	68.9 kN
Basic static load rating - C ₀	49 kN
Fatigue load limit - P _u	2 kN
Reference speed	10000 r/min
Limiting speed	6700 r/min
Calculation factor - k _r	0.025
Calculation factor - f ₀	14.7
Category	Single Row Ball Bearings
Inventory	5.0
Manufacturer Name	SKF
Minimum Buy Quantity	N/A



Qingdao Clunt Bearing Co., Ltd.

Weight / Kilogram	1.21
EAN	7316577094377
Product Group	B00308
Enclosure	Open
Precision Class	ABEC 1 ISO P0
Maximum Capacity / Filling Slot	No
Rolling Element	Ball Bearing
Snap Ring	No
Internal Special Features	No
Cage Material	Steel
Internal Clearance	C0-Medium
Inch - Metric	Metric
Long Description	75MM Bore; 130MM Outside Diameter; 25MM Outer Race Diameter; Open; Ball Bearing; ABEC 1 ISO P0; No Filling Slot; No Snap Ring; No Internal Special Features
Category	Single Row Ball Bearing
UNSPSC	31171504
Harmonized Tariff Code	8482.10.50.68
Noun	Bearing
Keyword String	Ball
Manufacturer URL	http://www.skf.com
Manufacturer Item Number	6215
Weight / LBS	2.66
Outer Race Width	0.984 Inch 25 Millimeter
Outside Diameter	5.118 Inch 130 Millimeter
Bore	2.953 Inch 75 Millimeter
d ₁	92.05 mm
D ₂	116.5 mm
r _{1,2} min.	1.5 mm



Qingdao Clunt Bearing Co., Ltd.

d_a min.	84 mm
D_a max.	121 mm
r_a max.	1.5 mm
Basic dynamic load rating C	68.9 kN
Basic static load rating C_0	49 kN
Fatigue load limit P_u	2.04 kN
Calculation factor k_r	0.025
Calculation factor f_0	14.7
Mass bearing	1.19 kg